

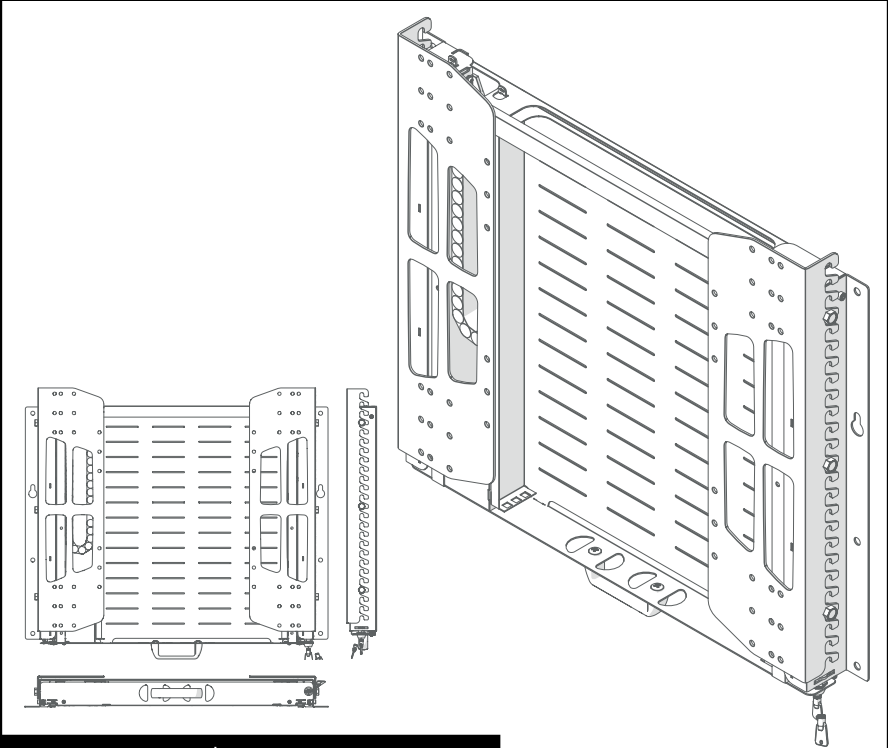

## VTS1 / VTS2



**Screen Size: 40 - 110" | Guide Max. Weight: 60-110kg**

\*Please check model specific details before installing\*

Revised 19/04/24

### WARNING

Please carefully inspect the product before assembling. If you notice any apparent damage, call your carrier claims agent and do not continue the installation until it has been reviewed. Please watch for pinch points. Do not put your fingers between moveable parts. Do not tamper with or disassemble any spring loaded parts. Before installing, make sure that the supporting surface will support five times the combined load of the solution and the hardware. Never exceed the maximum load capacity. Please also layout all components to ensure that you have all of the required parts before proceeding (see BOM list on following page). Use of this product for anything other than its specified use may result in failure or personal injury. This product is intended for indoor use only. We recommend using a qualified trades person for installation. Use an assistant or lifting equipment to lift and position products.

For support, please call: +44 (0)1865 767676 or email: sales@unicol.com



#	TOOLS REQUIRED
1	Pozi Head Screwdriver
4	17mm Socket Wrench

INSTALLERS REQUIRED
<b>1-2</b>

**COMPONENTS**

#	DESCRIPTION	QTY
1	VTS Body	1
2	VTS Removeable Cassette	1
3	VTS Arms	1
4	Security Keys	2
5	Drawer Handle (pre-attached)	1

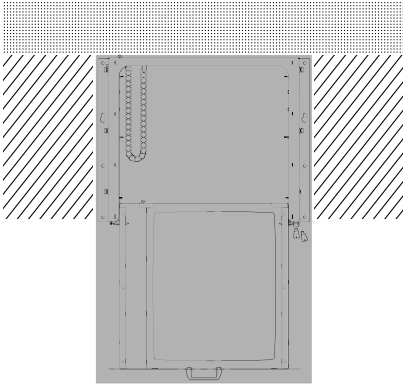

## POSITIONING OF SERVICES

Do **NOT** position services within body of VTS or within cassette path.  
 HTS1: 1185x785mm | HTS2: 906x635mm

Recommended position - either side of the VTS and behind the screen (size dependant).

Additional space for VTS1 only - dependant on the size of screen (*check before installing*).

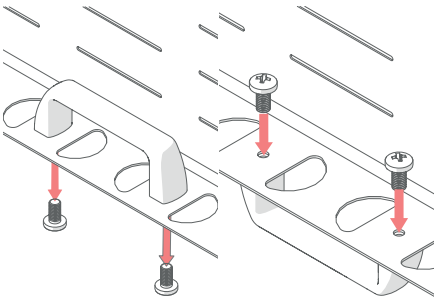

## STEP 2

Remove x2 M6x12 pozi pan head screws from handle in transport position (left image). Screw handle in operational position using same screws (right image)

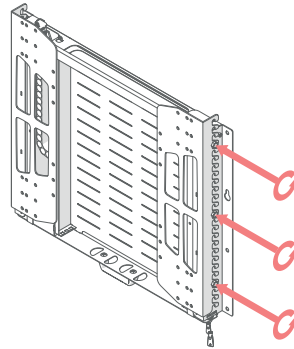

## STEP 1

Partially unwind hex head screws to release arms. Lift off arms and place aside.

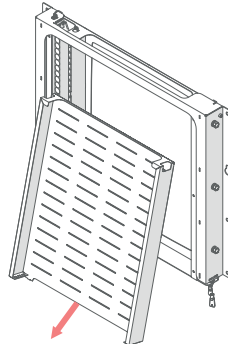

## STEP 3

Take out removeable cassette and populate with your media equipment.

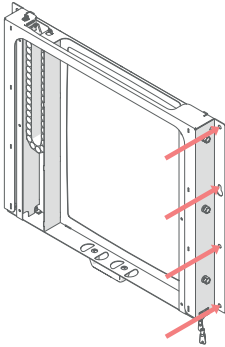

**STEP 4**

Position your mount by ensuring that the handle of the mount will sit just above the edge of the screen (see below). Once positioned, mark and drill 4x fixing holes each side. Fix in place using 8x suitable fixings (not supplied).

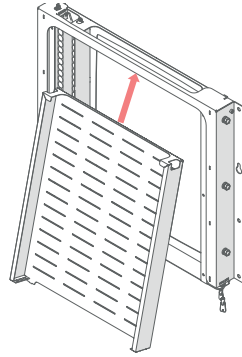

**STEP 5**

Return equipment tray to cassette and cable up your media equipment using the cable management system on the side of the mount.

Small VESA Patterns  
 Large VESA Patterns

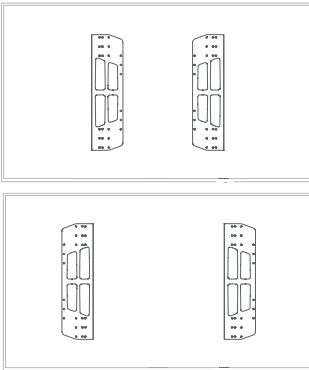

**STEP 5**

Fix arms to screen. There are two ways of doing this as shown above. This is dependent on your screen's VESA pattern.

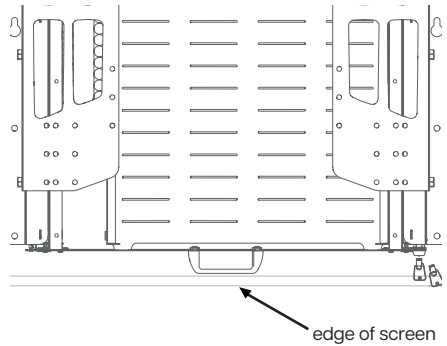

**STEP 6**

Hook arms onto the mount. Hook on at correct height so as the handle is always covered by the screen (as shown above).