

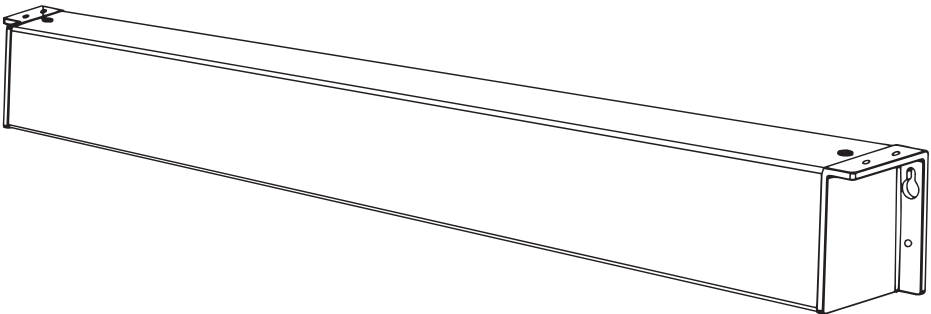

## User manual

celexon screen Electric  
Professional Plus battery



Thank you for choosing a quality product from celexon.  
Please read the instructions carefully before using the screen  
and keep them for future reference!

## Safety instructions

This manual is intended to familiarize you with the operation of this product. Keep this manual in a safe place so that you can access it at any time.

- Before mounting, please read the user manual and further safety and usage instructions.
- Do not start installation before reading and understanding the operating instructions.
- This product should only be installed by qualified personnel with mechanical and electrical knowledge.
- Perform the installation with another person to ensure safe installation
- Tighten the screws, but do not overtighten them. Over tightening (for example by using a cordless screwdriver) can cause damage and interfere with the screen's secure hold.
- This product is intended for indoor use. Outdoor use may cause damage to the product.
- Hanging points must be checked for strength and carrying capacity at least twice a year.
- Use the product only in its intended manner. Any other use may cause damage to the product or its surroundings.
- If you notice any external damage to the device or unexpected or unusual functions, the product may not be used further. In these cases, switch off the product immediately and remove it from the mains. Immediately contact the dealer from whom you purchased the product or celexon directly (WEB: [www.celexon.co.uk](http://www.celexon.co.uk), MAIL: [info@celexon.co.uk](mailto:info@celexon.co.uk)) for more information.
- Failure to follow the instructions above may result in personal injury or damage to the product or equipment connected to it. In case of incorrect installation or use, the warranty may also be void.
- If you are unsure when using the product, contact a specialist, your dealer or celexon directly (WEB: [www.celexon.co.uk](http://www.celexon.co.uk), MAIL: [info@celexon.co.uk](mailto:info@celexon.co.uk)). Subject to technical changes and errors..
- Children should not use the screen unattended or play underneath.

## Safety instructions

Please read the following instructions carefully and keep them for later use. The manufacturer **assumes no responsibility for damage to property or personal injury** when the screen is used outside the recommended specifications, or in case of improper installation.

**Do not use this screen near heaters or air conditioners. Also, do not mount the product in direct sunlight or in front of a window.** Due to the temperature-sensitive PVC surface, it can lead to lasting damage to the projection screen. We recommend that you wait approx. 2 hours after delivery for the installation to allow the fabric to acclimatize; especially when the screen is brought from cold to warm surroundings. Please avoid any stains on the cloth surface as these could possibly not be removed. **The positions of the endpoints are already set optimally at the factory and should not be changed.** Especially with motor screens, the entire length of the fabric should always be used to ensure the best flatness. An adjustment of a few cm of the end stop points should only be made by persons with specialist knowledge and in consultation with the manufacturer. An incorrect setting may damage the screen.

## Care Instructions

NEVER clean the screen with alcohol or other detergents that contain solvents. Use only a soft and clean cloth with a mild soapy water, if necessary. Be sure to avoid contact with sharp objects as these could permanently damage the projection screen fabric. Further information can be found in the enclosed screen information.

## Electric Specification

Voltage: 100V~120V, 60Hz or  
220V~240V, 50Hz  
Consumption: 30W (MAX)

Integrated Battery: DC 10.8V, 2600mAh  
Power Supply: DC 12,6V, 1A

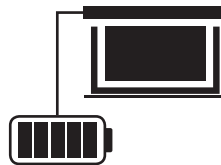

## In the box

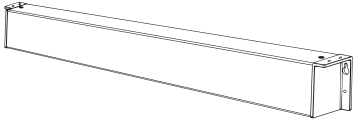

a) 1 x Screen with integrated mounting points



b) 1 x Radio remote control

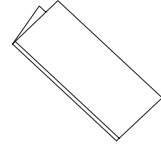

c) 1 x User Manual



d) 4 x Plastic Rawl plug



e) 4 x Screws for wall and ceiling mounting  $\varnothing 4 \times 50 \text{mm}$



f) 2 x Plate

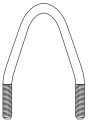

g) 2 x Hanging loops



h) 4 x Lock nut



i) 1 x 12.6V 1A USB power adapter

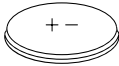

Required (Not included):  
Battery button cell CR2450 for remote control

## Installing the Screen

Install the screen at a location visible to all viewers; ideally, the screen should be mounted in the center and in sight of the spectators. The lower third of the screen should be approximately at eye level of the viewer. Install the screen straight and level otherwise there is a risk that the screen cloth is skewed when unwound. With this screen you have the possibility to choose between three mounting options:

**Option 1:** Ceiling Mount

**Option 2:** Wall Mount

**Option 3:** Floating Ceiling Mounted via Hanging Loops  
(on ceiling hooks - not included)

## Installing the Screen

### Option 1: Ceiling mounting (screwed)

**ATTENTION! Make sure that you are using stable ground.**

Measure the distance (A) of the holes in the endcaps (two holes per side) and transfer the distance to the ceiling. Make sure that the holes are straight and level (parallel to the wall).

**ATTENTION only on stone surfaces:** Pre-drill the holes and insert the plugs (d). Use appropriate plugs and screws for the mounting surface (if necessary, suitable materials must be purchased separately). Then place the plate (f) (one plate per side cap) on the holes in the end cap. Use the screws (e) to mount the screen to the ceiling.

**CAUTION:** Tighten the screws, but do not over tighten them. Over tightening (for example by using a cordless screwdriver) can cause damage and interfere with the screen's secure hold. If you notice cracks in the side cap, they need to be replaced. The screen must not be used with defective caps. Please contact celexon directly for replacement caps (WEB: [www.celexon.co.uk](http://www.celexon.co.uk), MAIL: [info@celexon.co.uk](mailto:info@celexon.co.uk)).

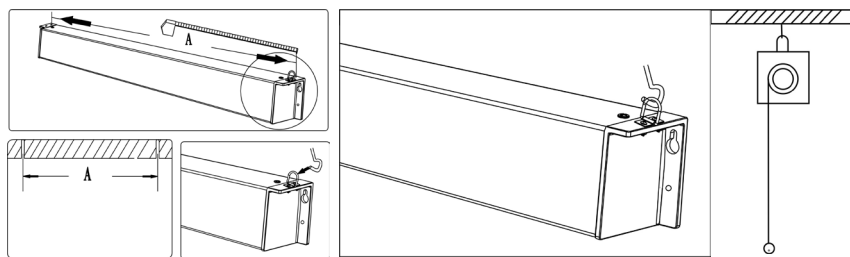

### Option 2: Wall mounting (screwed)

**ATTENTION! Make sure you are using stable ground.**

Measure the distance (A) of the holes in the endcaps (two holes per side) and transfer the distance to the wall. Make sure that the holes are straight and in scale.

**ATTENTION only on stone surfaces:** Pre-drill the holes and insert the plugs (d). Use appropriate plugs and screws for the mounting surface (if necessary, suitable

## Installing the Screen

materials must be purchased separately). Use the screws (e) and screw into the top hole, leaving a gap of 1cm. Hang the screen to the wall via the top mounting hole and check again that the screen is level. You can then tighten this screw.

**CAUTION:** Tighten the screws, but do not over tighten them. Over tightening (for example by using a cordless screwdriver) can cause damage and interfere with the screen's secure hold. If you notice cracks in the side cap, they need to be replaced. The screen must not be used with defective caps. Please contact celexon directly for replacement caps (WEB: [www.celexon.co.uk](http://www.celexon.co.uk), MAIL: [info@celexon.co.uk](mailto:info@celexon.co.uk)).

Then screw through the lower screw hole and make sure that the screws are not tightened too tight.

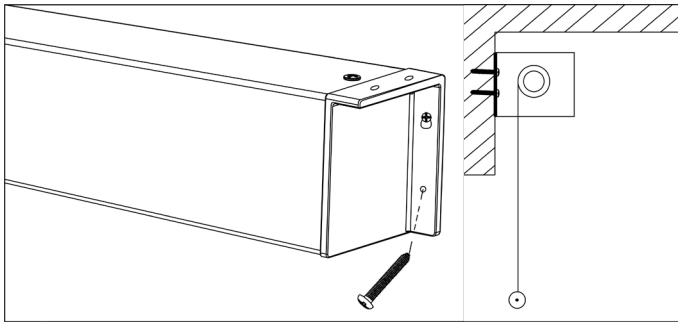

### **Option 3: Suspended ceiling mounting via suspension eyelets (on ceiling hooks - not included)**

**ATTENTION! Make sure that you use a stable surface.**

Place the plate (f) (one plate per side cap) underneath the holes of the end cap and guide the hanging loop (g) through the side cap and plate from above. Then tighten the loop with the lock nut (h) from below. Measure the distance (A) of the loops and transfer the distance to the ceiling. Make sure that the loops are in alignment with each other and that the marking is parallel to the wall.

**ATTENTION:** Mounting material such as ceiling hooks are not included in this installation option and must be purchased separately.

## Installing the Screen

Once the ceiling hooks are mounted, the screen can be hung on the loops.

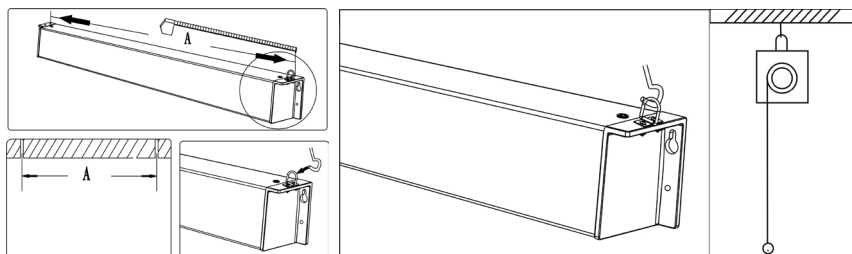

## Operating the screen

### Operation of the radio remote control



- 1) Press the „Up“ button on the remote control. The screen will automatically drive to the upper end position and automatically stop.
- 2) Press the „Stop“ button on the remote control. The movement of the screen stops immediately.
- 3) Press the „Down“ button on the remote control. The screen will automatically drive to the lower end position and automatically stop.

### Pairing the radio remote

The radio remote control is already factory-paired with the integrated receiver. If the pairing is canceled, please proceed as follows:

- 1) Press the „Up“ button for 3 seconds until the remote control LED lights, and connect the power cord to the screen. A beep confirms the pairing mode started.
- 2) Release the „Up“ button when you hear the beep.
- 3) Briefly press and release the „Up“ button. When the beep sounds 3 times quickly, the remote control pairing is complete.

# EU / EC Declaration of Conformity

**Manufacturer:** celexon Europe GmbH

**Adresse:** Gutenbergstraße 2, 48282 Emsdetten, DE

hereby declares that the following celexon branded product

**Product name:** celexon screen Electric Professional Plus Battery

complies with the essential requirements of the EU Directives listed below - in accordance with the instructions given by the manufacturer, corresponds to:

## Electromagnetic compatibility (2014/30 / EU)

-ETSI EN 301 489-1 V2.2.0 (2017-03)

-ETSI EN 301 489-3 V2.1.1 (2017-03)



The symbol indicates the separate withdrawal of electrical and electronic equipment in EU countries. Please do not throw the appliance in the household waste. Find out about the return system that is valid in your country and, if you have questions about the disposal process, contact your local authority or your local collection point.

## Radio Equipment Directive (2014/53 / EU)

### Article 3.1

a) Health

- EN 62479:2010

a) Safety

- EN 60950-1: 2006+A11: 2009+A1:  
2010+A12: 2011+A2: 2013

### Article 3.1

b) Electromagnetic compatibility

ETSI EN301 489-1 V2.2.0 (2017-03)

ETSI EN301 489-3 V2.1.1 (2017-03)

### Article 3.2

Radio frequency

ETSI EN300 220-2 V3.1.1 (2017-02)

ETSI EN300 220-1 V3.1.1 (2017-02)

## Restriction of Hazardous Substances (RoHS)

2011/65 / EU



Christoph Hertz  
Managing Director

Emsdetten, 27.06.19

**celexon**<sup>TM</sup> 